



**CATTERALL & WRIGHT**  
CONSULTING ENGINEERS  
1221 - 8th Street East  
SASKATOON SK S7H 0S5  
Tel: (306) 343-7280, Fax: (306) 956-3199

**ISSUED FOR OWNER USE**

**LEGEND:**

- XX.XX FINISHED GROUND AT HOUSE
- XX.XX FINISHED GROUND AT LOT CORNER
- ← DRAINAGE DIRECTION
- ⊙ HYDRANT
- ⊗ CURB STOP
- ══ ROLLED CURB & GUTTER

**BENCHMARK**  
PHILLIPS BAY & RANGE LINE ROAD  
HYDRANT TOP NUT ELEV. 30.760

PHILLIPS BAY  
(END OF CUL-DE-SAC)  
HYDRANT TOP NUT ELEV. 31.145

SCALE VERIFICATION  
WHEN DRAWING IS PLOTTED FULL SIZE  
THIS LINE IS 30mm IN LENGTH.

DATE	REVISION
16/09/12	ISSUED TO OWNER
16/04/19	ISSUED FOR CONSTRUCTION
15/07/14	ISSUED FOR BID

OWNER  
**VILLAGE OF MUEENSTER**

LOCATION  
MUEENSTER, SK

PROJECT  
PHILLIPS BAY  
SITE GRADING

SHEET TITLE  
LOT GRADING PLAN

SCALE 1:500	DESIGNED EBG
DRAWN EBG	CHECKED PLS
DATE 14/12/01	SHEET 2 of 5

DRAWING NUMBER  
**128-02002**

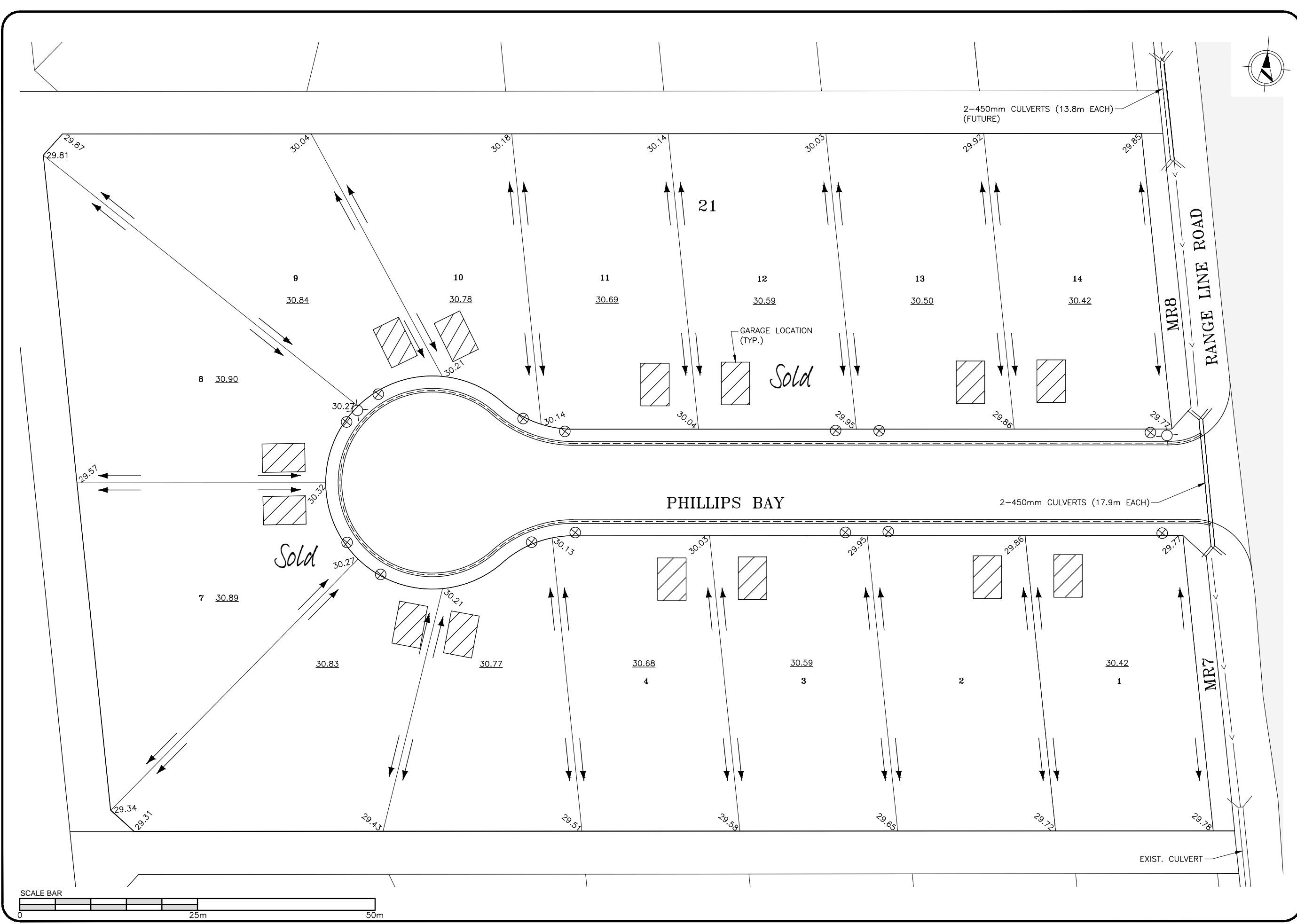

N:\Muenster - 128\018- Phillips Bay M&S\Working Drawings\128-018.dwg 12/09/16 - 11:01 A